

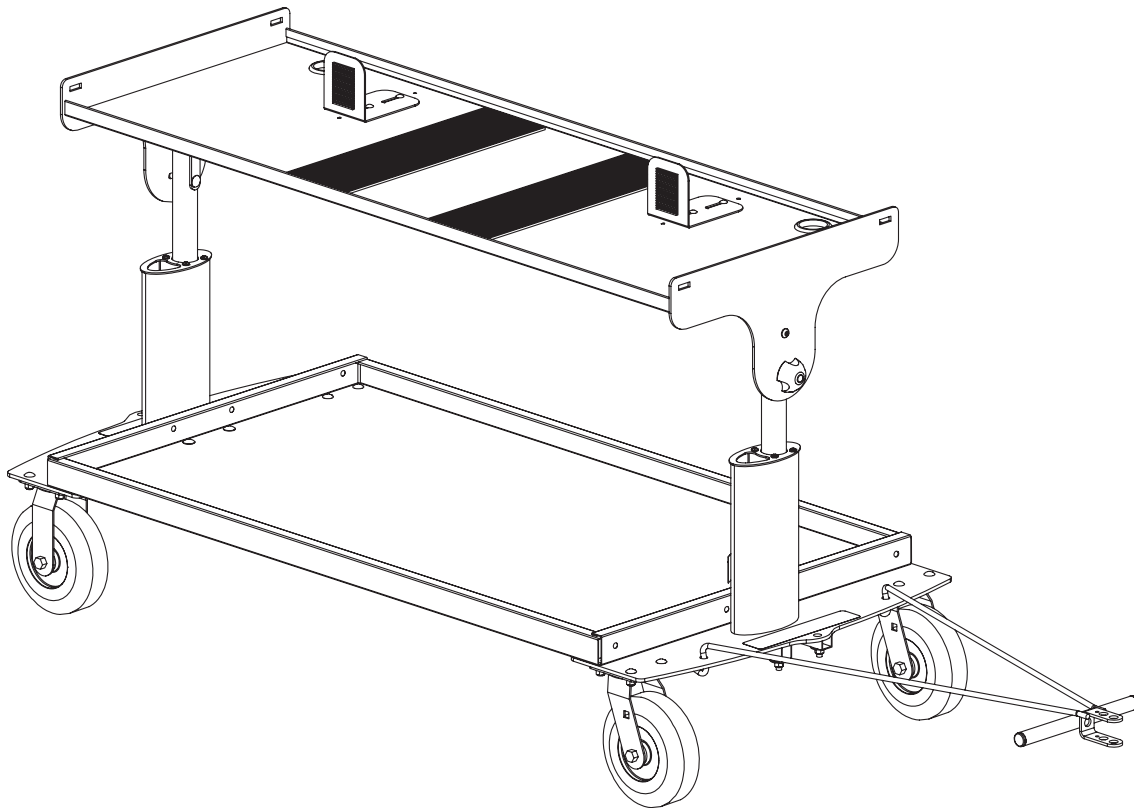

# Assembly Instructions and Owner's Manual OnBoard® Keyboard Cart



## Contents

Important User Information .....	2	Operation .....	9
Safety Precautions .....	3	Adjusting the Cart .....	10
General Operation .....	3	Loading the Cart .....	11
Required Tools .....	4	Moving the Cart .....	11
Supplied Hardware .....	4	Shelf Extension Accessory .....	13
Parts List .....	5	Storage .....	15
Assembly .....	6	Maintenance .....	15
		Replacement Parts .....	16



Visit the OnBoard Keyboard Cart web page at [wengercorp.com](http://wengercorp.com) for more information.

**Note:** Please read and understand these instructions before proceeding.  
**Note:** If you need additional information, contact Wenger Corporation using the information below.

# ***Important User Information***

---

## ***General***

Copyright © 2024 by Wenger Corporation

All rights reserved. No part of the contents of this manual may be reproduced, copied, or transmitted in any form or by any means including graphic, electronic, or mechanical methods or photocopying, recording, or information storage and retrieval systems without the written permission of the publisher, unless it is for the purchaser's personal use.

Printed and bound in the United States of America.

The information in this manual is subject to change without notice and does not represent a commitment on the part of Wenger Corporation. Wenger Corporation does not assume any responsibility for any errors that may appear in these instructions.

In no event will Wenger Corporation be liable for technical or editorial omissions made herein, nor for direct, indirect, special, incidental, or consequential damages resulting from the use or defect of these instructions. The manufacturer reserves the right to change this product at any time.

The information in this document is not intended to cover all possible conditions and situations that might occur. The end user must exercise caution and common sense when assembling or installing Wenger Corporation products. If any questions or problems arise, call the Wenger Corporation at (800) 4WENGER (493-6437) or +1-507-455-4100 worldwide.

## ***Manufacturer***

The OnBoard® Keyboard Cart is manufactured by:

Wenger Corporation  
555 Park Drive  
Owatonna, MN 55060  
(800) 4WENGER (493-6437) • +1 (507) 455-4100  
wengercorp.com

## ***Intended Use***

- This product is intended for indoor use in normal ambient temperature and humidity conditions — it must not be exposed to prolonged outside weather conditions.
- This product is intended to be assembled, installed and used only as described in these instructions.

## ***Warranty***

Warranty information is available at [wengercorp.com](http://wengercorp.com).

## Safety Precautions

---

Throughout this document you may find cautions and warnings which are defined as follows:

- **WARNING:** Failure to follow the instruction could result in serious injury or damage to property.
- **CAUTION:** Failure to follow the instruction could result in minor injury or damage to property.

Read and understand all of these safety instructions before any assembly, installation or use.

### **⚠ CAUTION**

*Make sure anyone assembling, installing or using this product has read and understands these instructions.*

### **⚠ CAUTION**

*Failure to comply with Warnings and Cautions in this document or on the equipment can result in damage to property or serious injury.*

## General Operation

### **⚠ CAUTION**

- *OnBoard Keyboard Cart maximum total load capacity is 40 lb (18 kg) uniformly distributed on the keyboard shelf, 120 lb (54 kg) uniformly distributed on the lower shelf and 40 lb (18 kg) on each shelf extension.*
- *The keyboard shelf, clamp and pads are only intended to hold the keyboard during performances or while moving to and from performance areas at a reasonable speed. Speed not to exceed 5 mph (8 kph).*
- *When the cart is left unattended, it must be placed in a secure position so that it does not move or roll into vehicles, structures or people.*
- *All four casters must be in contact with the floor or ground at all times.*
- *Always distribute the load evenly on the cart. Avoid top-heavy loading.*
- *Avoid ramps steeper than a one-foot rise or drop in a 12' (3658 mm) horizontal distance.*
- *Always move slowly up or down a ramp with the narrow end of the cart in the direction of travel.*
- *Do not pull or push too high on the cart or sides of the cart which may cause the cart to tip over.*
- *Avoid off-center loads which may cause the cart to tip over.*
- *Because swivel casters move in any direction, the operator must move the cart slowly and have a clear view to avoid obstructions and individuals standing in the direction of travel.*
- *If the cart is heavily loaded, two people are required to move the cart (one pushing at the rear and one guiding at the front).*
- *When transporting the cart in a vehicle it must be braced with tie-downs, chains or cargo straps designed specifically for that purpose so cart will not move.*
- *Blankets or other padding material may be required to avoid damage to the cart and accessories from vibration and impact during transport.*
- *When moving the cart, do not ride and do not allow others to ride on the cart.*
- *Do not transport people or stand on the cart.*
- *Use caution when removing objects from the cart or when placing objects on the cart.*
- *When towing the cart, avoid tight turns which may result in the tow vehicle making contact with the cart or tow bar.*

## Required Tools

---

- 9/16" Wrench or 9/16" socket with ratchet
- 7/32" Allen wrench (provided)

## Supplied Hardware

---

Hardware remaining after assembly can be discarded.

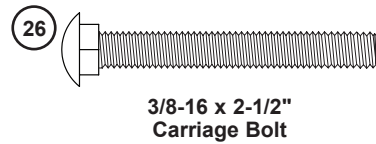
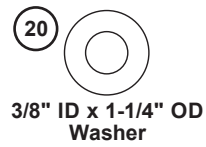
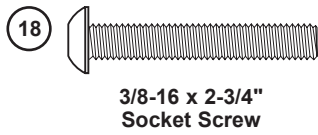
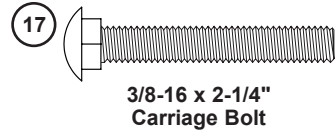
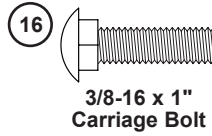
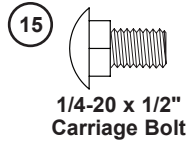

# Parts List

Item	Description	Item	Description
1	Base Assembly	7	Rubber Grommet
2	Swivel Caster	8	2.48" (63 mm) Dia Knob
3	Rigid Caster	9	Keyboard Clamp Bracket
4	Tow Bar	10	Top Shelf
5	6" x 21" Black Rubber Pad	11	Bottom Shelf
6	Keyboard Pivot Lock Plate	12	Cross Member

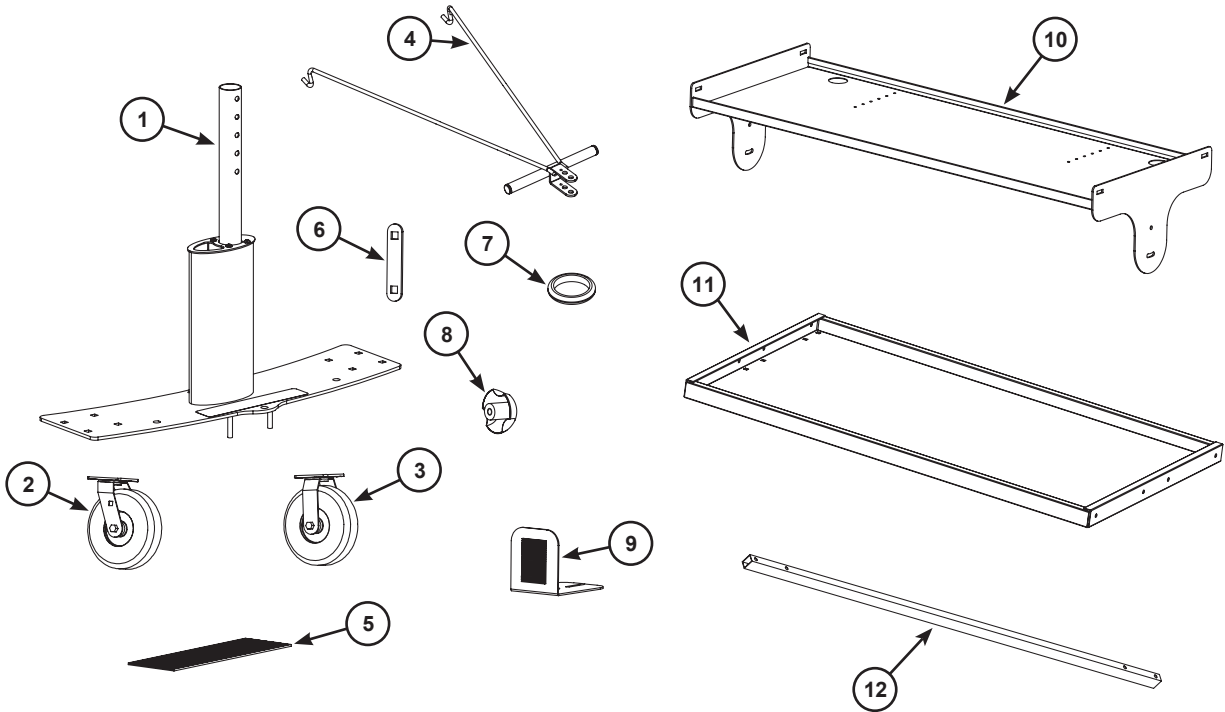

# Assembly

Assemble casters (2 and 3) to the base assembly (1).

1. Align the swivel casters (2) with the bolt holes on the base assembly (1).
2. Assemble the casters to the base assembly (1) using two 3/8-16 x 1" carriage bolts (16) and lock nuts (19).  
At this point, only attach the casters using the outside holes (tow hole side) on the base assembly. Do not fully tighten. **(Detail A)**

## NOTICE

**The same caster type (swivel or rigid) must be assembled to each base assemblies.**

3. Align the rigid casters (3) with the bolt holes on the remaining base assembly (1).
4. Repeat step 2.

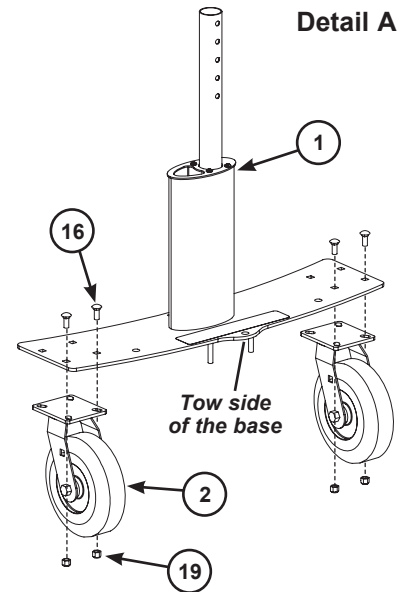

Assemble the cross members (12) to the base assemblies (1).

5. Lay the base assemblies on end.
6. Align the cross member (12) to the bolts located on the bottom of the base assemblies. **(Detail B)**
7. Secure the cross member to the base assemblies using 3/8" washers (20) and 3/8" lock nuts (19).

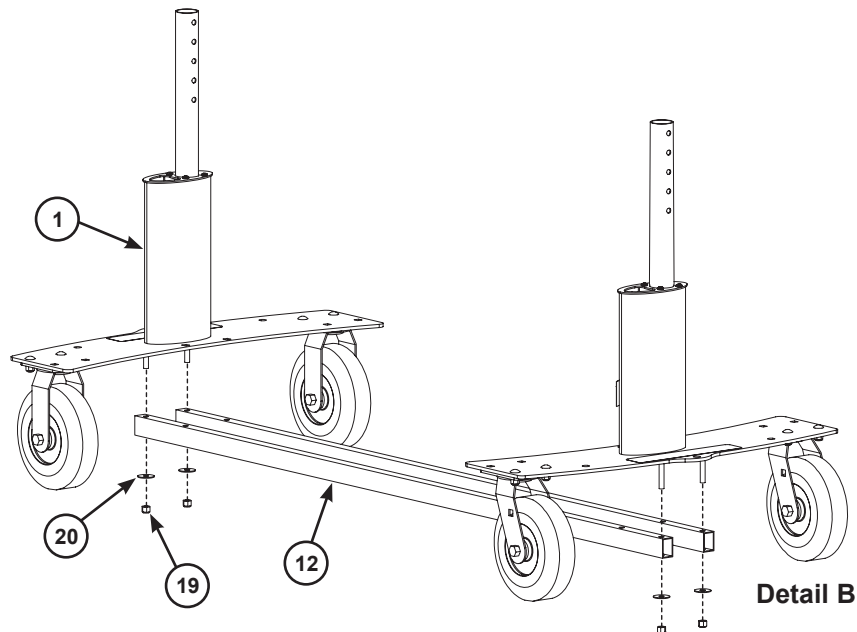

## Assembly (continued)

Assemble the bottom shelf onto the cart base.

### **CAUTION**

**Two people are recommended to complete the next steps.**

1. Align the bottom shelf (11) on the inside of the base assemblies (1). **(Detail C)**
2. Secure the bottom shelf, in the corners, to the base assemblies and casters using eight 3/8-16 x 1" carriage bolts (16) and 3/8-16 lock nuts (19).
3. Secure the bottom shelf, at the center, through the base assemblies and cross members (12) using four 3/8-16 x 2-1/4" carriage bolts (17), washers (20) and 3/8-16 lock nuts (19).

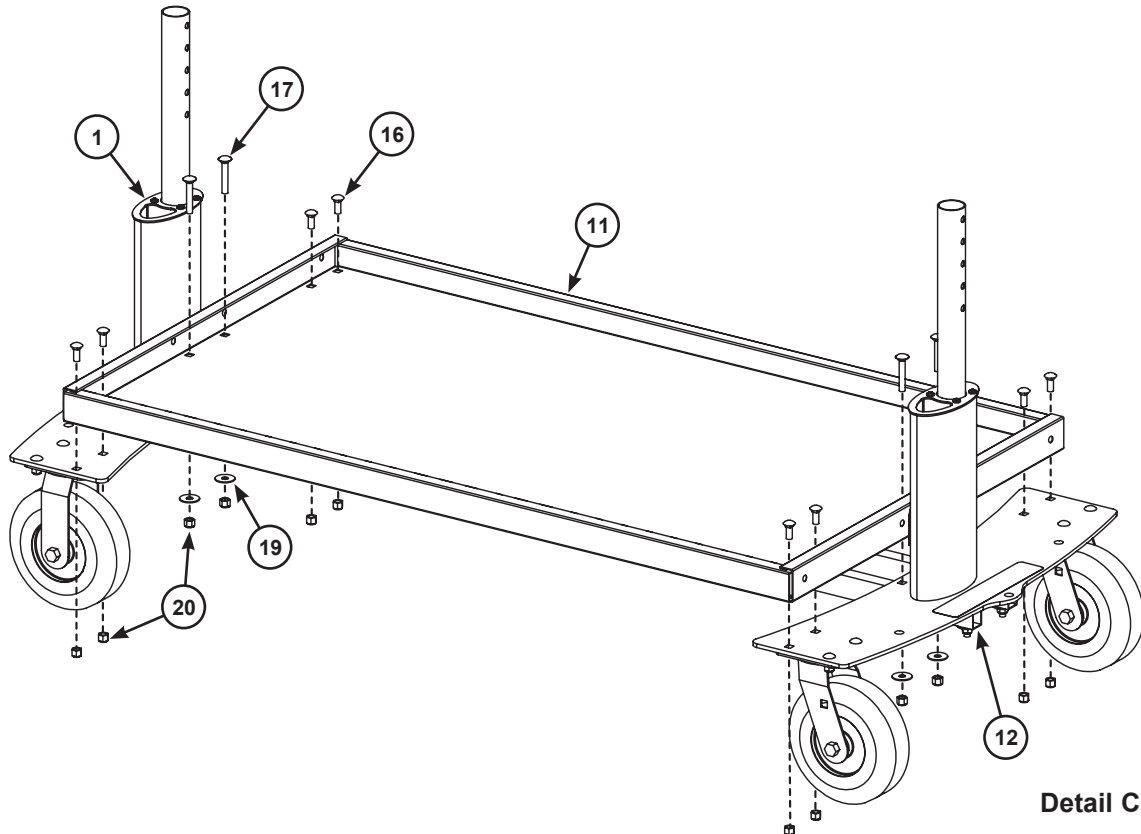

4. Tighten all the lock nuts.

## Assembly (continued)

Assemble the top shelf onto the cart.

### **CAUTION**

*Two people are recommended to complete the next steps.*

Vertically align the top shelf (10) at the top of the base assemblies (1) at desired location. **(Detail D)**

### **NOTICE**

*The vertical height of the shelf on the cart is adjustable.*

1. Insert a 3/8-16 x 2-3/4" socket screw (18) through the top shelf and base assembly.
2. Place the keyboard pivot lock plate (6) on the socket screw (18) against the base assembly.
3. Secure the pivot lock plate using a 3/8-16 jam lock nut (25).
4. Insert a 3/8-16 x 2-1/2" carriage bolt (26) through the pivot lock plate, base assembly and top shelf.
5. Tighten the black knob (8) onto the carriage bolt (26)
6. Repeat 1-5 on the opposite side of the cart.
7. Insert the rubber grommet (7) into the pre-cut hole on the top surface of the top shelf.

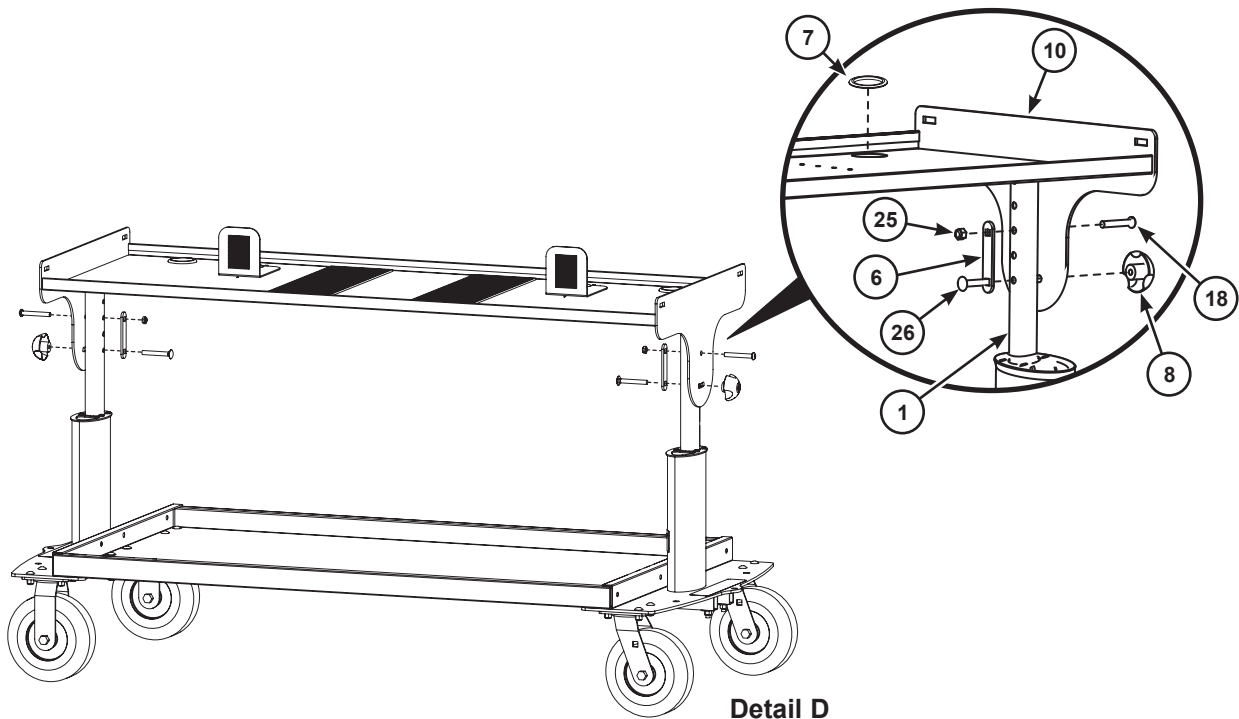



## Operation

Always observe the "Safety Precautions" in these instructions.

**Failure to comply with the "Safety Precautions" in these instructions can result in serious injury.**

1. Make sure the cart is secure and does not roll away while loading, unloading, being stored, parked or during a performance.
2. Position and adhere the rubber pads (5) to best suit the contact point of the keyboard being mounted onto the cart.

The pads may be cut into smaller pieces as desired and also placed along the inside edge of the front lip where the keyboard may make contact. **(Detail A)**

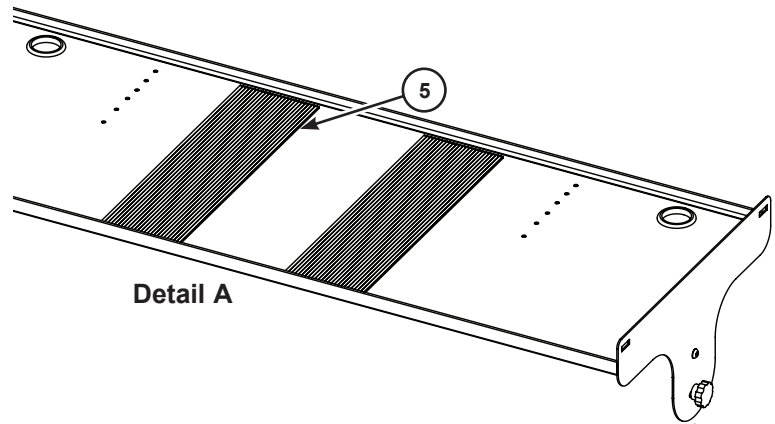

3. Position the keyboard bracket clamp (9) on the top shelf in the applicable location to secure the keyboard being mounted on the cart. **(Detail B)**
4. Using the carriage bolt, 1/4-20 x 1/2" (15) and wing nut 1/4-20 (21), secure the keyboard bracket clamp (9) with the rubber pad making contact with the keyboard.

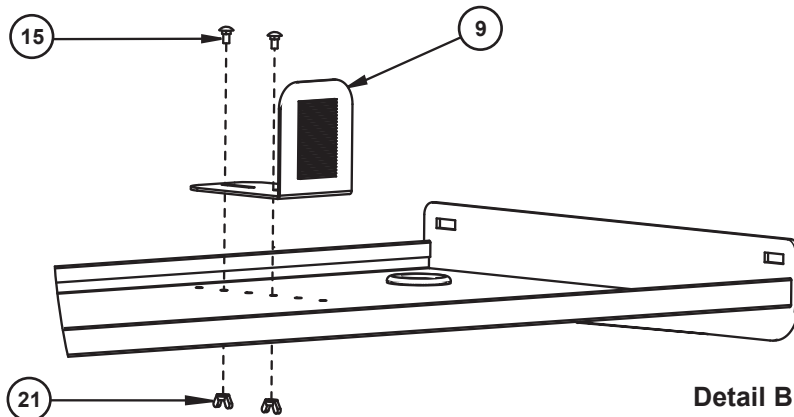

### **CAUTION**

*The keyboard clamp, pads and top shelf are intended to hold the keyboard during performances or to and from the performance area at reasonable speeds. Speed not to exceed 5 mph (8 kph). The keyboard must be removed or secured with additional straps, cords, etc., if the cart is being transported in a vehicle or over obstacles.*

## **Operation (continued)**

---

### **Adjusting the Cart**

The top shelf (10) is adjustable vertically and also can be tilted up to 10°.

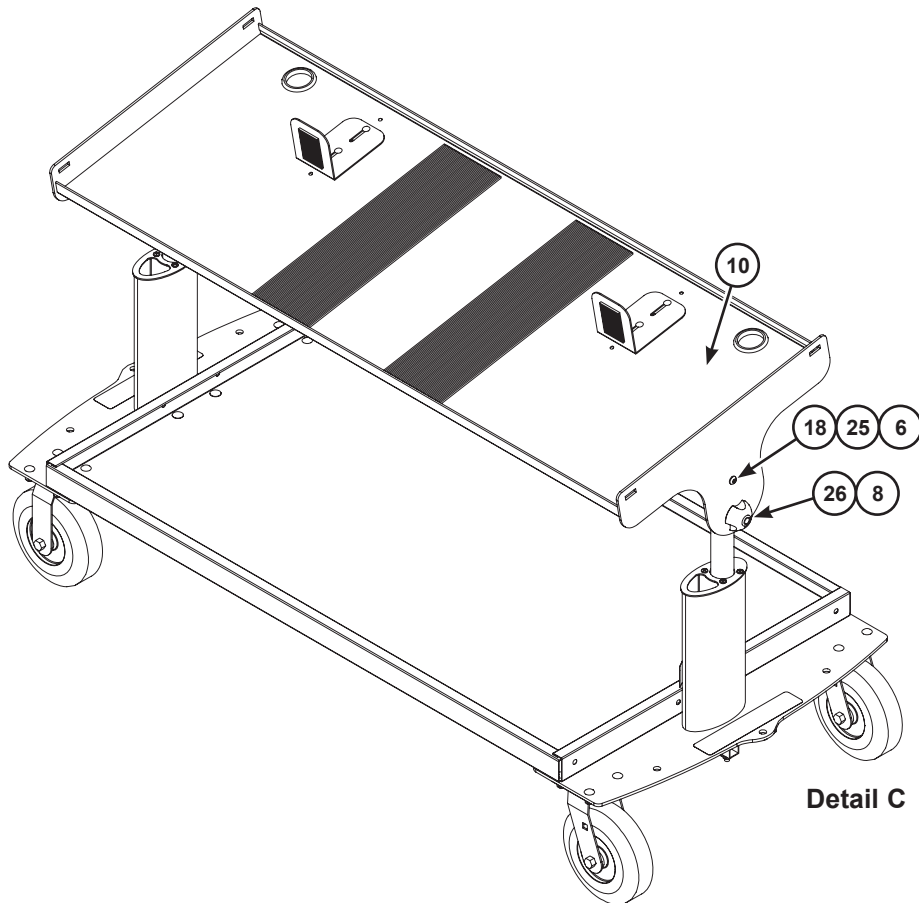

### **To Adjust the Top Shelf Vertically (Detail C)**

1. Remove the jam lock nut (25), carriage bolt (26), black knob (8), socket screw (18) and keyboard pivot lock plate (6) while holding the top shelf (10) on one end.
2. Place the top shelf (10) in the desired location.
3. Reinstall the hardware removed in step 1 in the following order:
  - keyboard pivot lock plate (6)
  - socket screw (18)
  - black knob (8)
  - carriage bolt (26)
  - jam lock nut (25)
4. Repeat 1-3 on the opposite side of the cart.

### **To Tilt the Top Shelf (Detail C)**

1. Loosen the black knob (8) located on both ends of the cart.
2. Adjust the top shelf to the desired radius (maximum 10°).
3. Tighten the black knob (8) on both ends of the top shelf.

## Operation (continued)

---

### Loading the Cart

1. Always distribute loads evenly on the keyboard cart.
  - 40 lb (18 kg) max. on keyboard shelf
  - 120 lb (54 kg) max. on lower shelf
  - 40 lb (18 kg) max. on each shelf extension

### Moving the Cart

1. When the cart is left unattended, it must be placed in a secure position so that it doesn't move or roll into vehicles, structures or people.
2. When pulling or pushing the keyboard cart, always pull or push at waist level or lower. Pushing above the main support bar can tip the keyboard cart over easily. **(Detail D)**
3. If the cart is heavily loaded, two people should work together to move the cart in the direction of travel that the rigid casters can move freely. One person pushing at the rear and one person guiding at the front. Take care to avoid stationary objects or people standing in the path of the cart.

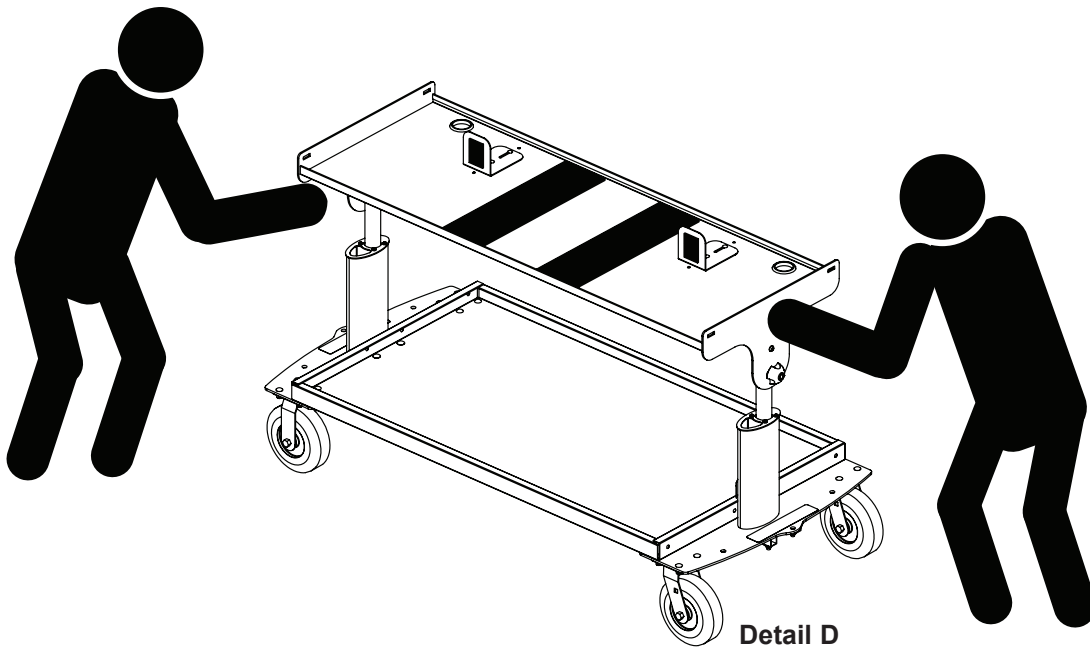

### **CAUTION**

*Never transport people or stand on the cart.*

## Operation (continued)

### Moving the Cart (continued)

4. A separate tow bar (4) is provided which inserts into two holes in the base assembly (1). The tow bar (4) may be used as a handle to pull the keyboard cart manually or can be attached horizontally to a lawn and garden tractor. (Detail E)

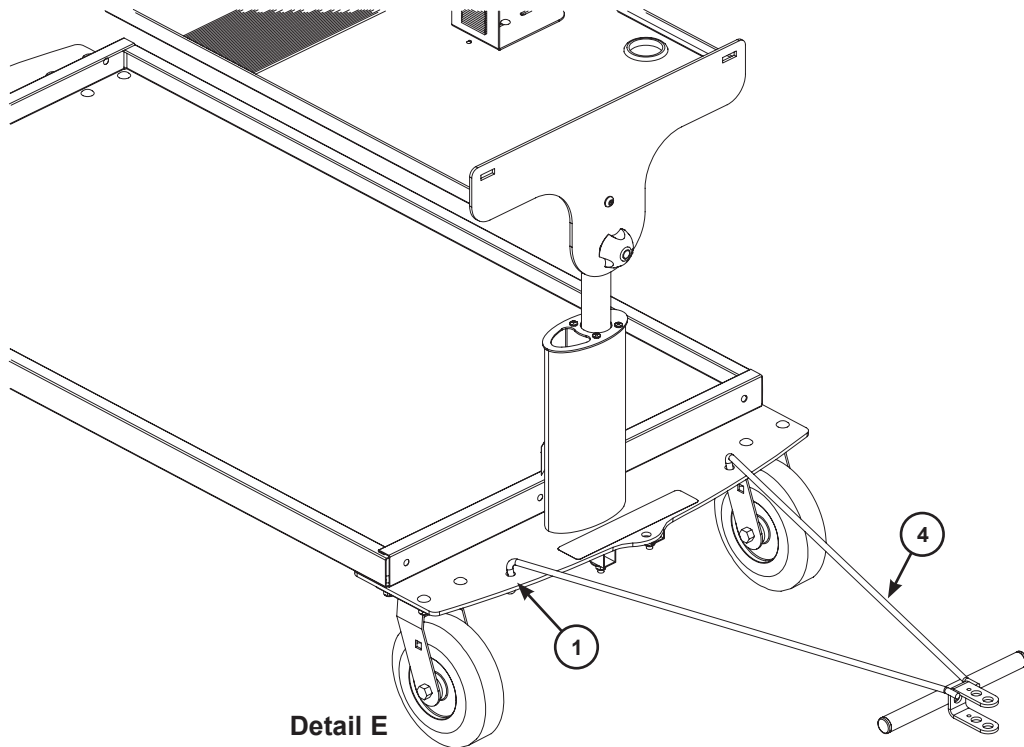

### **⚠ CAUTION**

*When towing the cart, avoid tight turns which may result in the tow vehicle making contact with the cart or tow bar.*

### **⚠ CAUTION**

*Towing speed is not to exceed 5 mph (8 kph).  
The number of carts being towed is not to exceed three carts together.  
Abrupt stops with heavy loads may cause the tow bar to bend.  
The tow bar may be straightened if this happens.*

5. When the tow bar is removed, store it out of the way so that it is not an obstruction or hazard.
6. If the keyboard cart is transported in a vehicle, it must be braced or strapped to the vehicle so that it will not move. Bracing must use tie-downs or straps specifically designed to prevent the keyboard cart from moving in the vehicle.  
Remove instruments that may be damaged during transport. Secure the keyboard cart at the lower frame. Pads or other protection against abrasion may be required.

## Shelf Extension Accessory

---

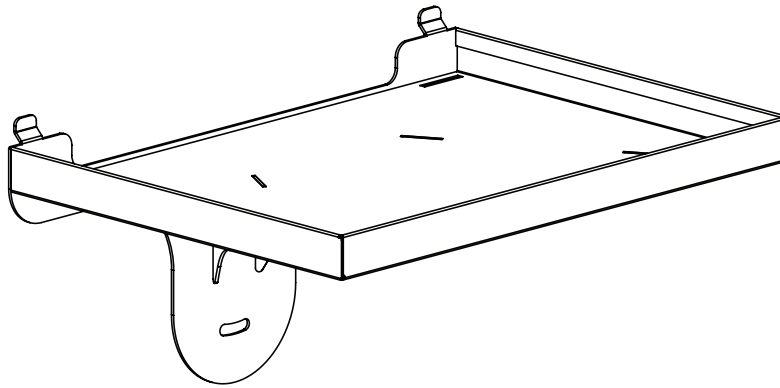

1. Support one end of the top shelf (10). **(Detail F)**
2. Remove black knob (8) and socket screw (18). **(Detail F)**

### **CAUTION**

*Two people are required.  
The top shelf (10) is now loose on one end and must be supported.*

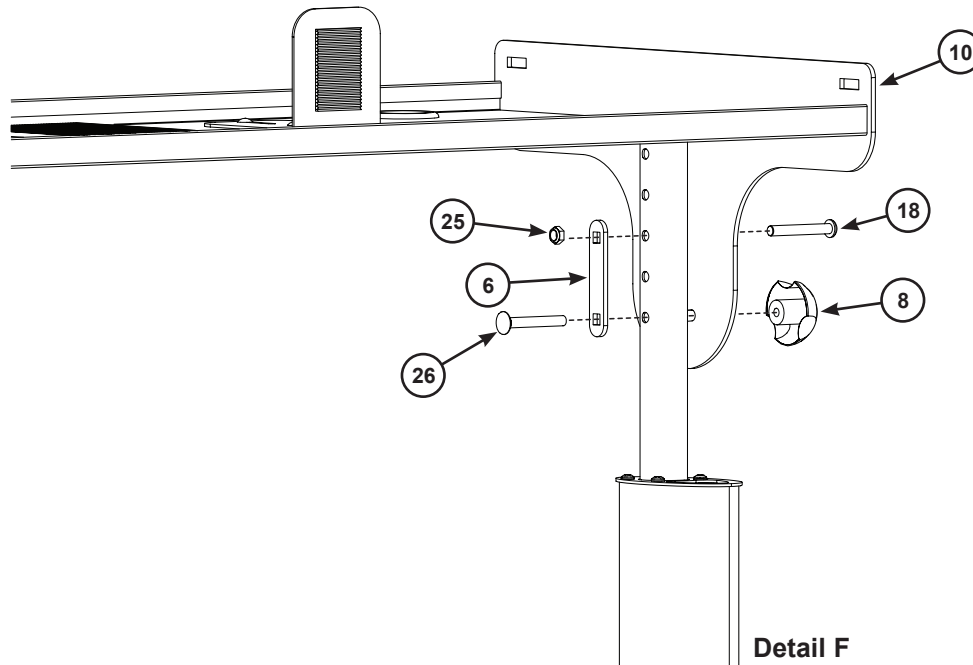

## Shelf Extension Accessory (continued)

3. Tilt the shelf extension up and insert the two tabs into the two slots at the end of the top shelf. (Detail G and H)

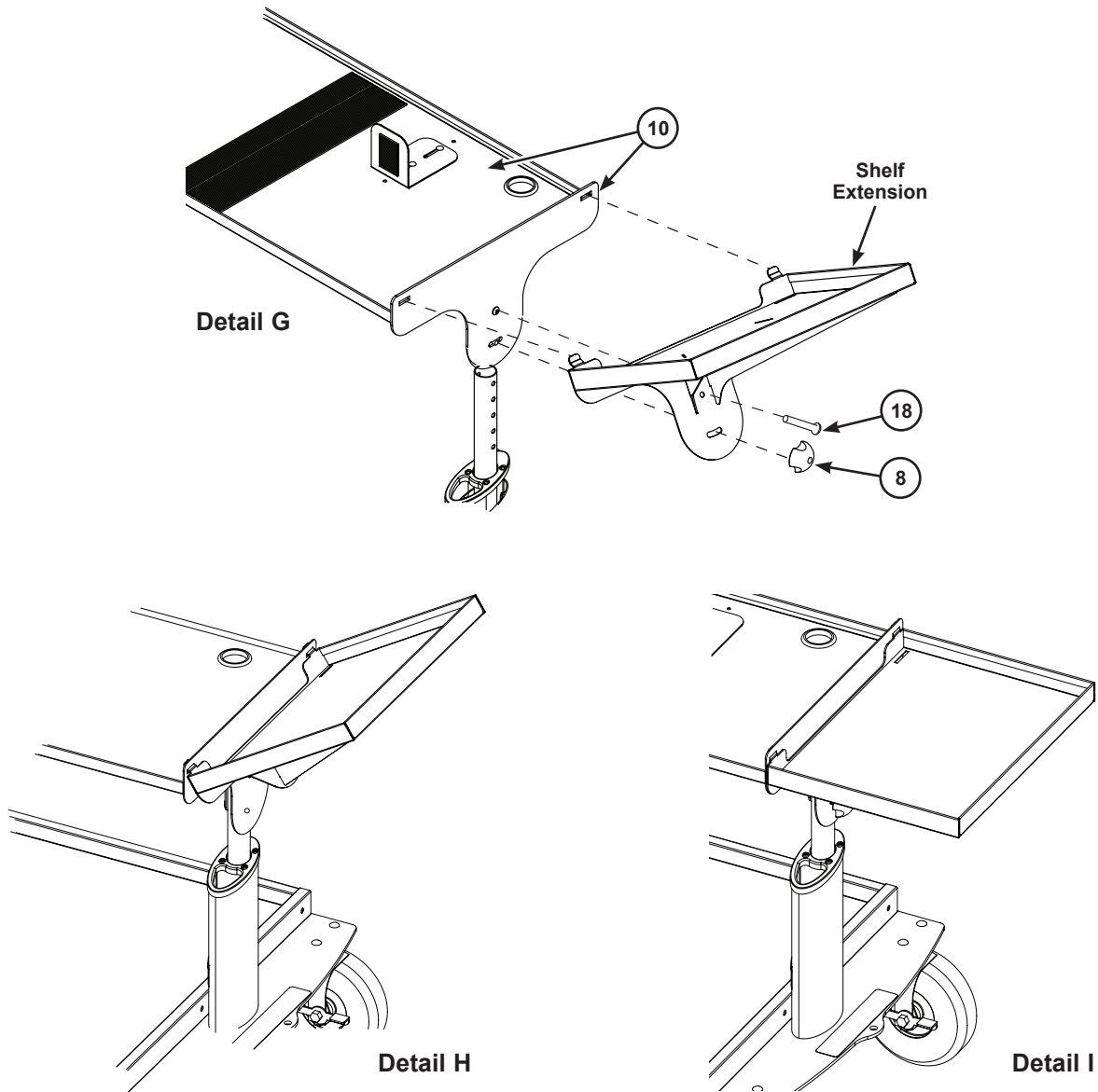

4. Lower the end of the shelf extension (Detail I) and re-insert the socket screw (18) through the shelf extension, top shelf (10), base assembly (1), pivot lock plate (6) and jam lock nut (25). (Detail F)
5. Replace the black knob (8) and tighten all fasteners. (Detail F and G)
6. Repeat steps 1 - 5 on the opposite side of the cart for the other shelf extension.

## ***Storage***

---

1. When leaving the cart in a stationary position or in storage, always block or secure the casters to prevent the cart from moving and possibly causing damage.

## ***Maintenance***

---

1. Clean the cart with a mild detergent and warm water. Avoid using harsh or abrasive cleaning products.
2. Immediately replace any caster wheels that do not rotate or turn freely.
3. Immediately replace or repair any tire that develops a flat area.
4. Recommended tire pressure is 50 psi (344 kPa). Do not exceed the maximum tire pressure shown on the sidewall of the tire.
5. During heavy usage, periodically check and tighten the fasteners.
6. Grease zerks and bushings if required.

# Replacement Parts

Item	Description	Item	Description
1	Base Assembly	14	1/4" Lock Washer
2	9" (229 mm) Dia Swivel Caster	15	1/4-20 x 1/2" Carriage Bolt
3	9" (229 mm) Dia Rigid Caster	16	3/8-16 x 1" Carriage Bolt
4	Tow Bar	17	3/8-16 x 2-1/4" Carriage Bolt
5	6 X 21 Rubber Pad	18	3/8-16 x 2-3/4" Socket Buttonhead Cap Screw
6	Keyboard Pivot Lock Plate	19	3/8-16 Lock Nut
7	Rubber Grommet	20	3/8 ID x 1-1/4" OD Washer
8	2.48" (63 mm) Dia Knob	21	1/4-20 Wing Nut
9	Keyboard Clamp Bracket	22	Extrusion Cap
10	Top Shelf	23	Upright Extrusion
11	Bottom Shelf	24	1/4-20 x 3/4" Self Tap Screw
12	Cross Member	25	3/8-16 Jam Lock Nut
13	1/4-20 x 1-1/4" Self Tap Screw	26	3/8-16 x 2-1/2" Carriage Bolt

